

PARTS LIST						
ITEM	QTY	PART NO.	PART DESCRIPTION	LENGTH	UNIT WT.	NET WT.
1	6	X-CR-LPAA	3 1/2 X 2 1/2 X 5/16" ANGLE (50KSI)	31 3/4 in	15.95	95.69
2	12	G5802	5/8" x 2" HDG HEX BOLT GR5		0.27	3.24
3	12	G58TRI-LNUT	5/8" HDG HEAVY 2H TRI-LOCK NUT		0.14	1.64
					TOTAL WT. #	95.45

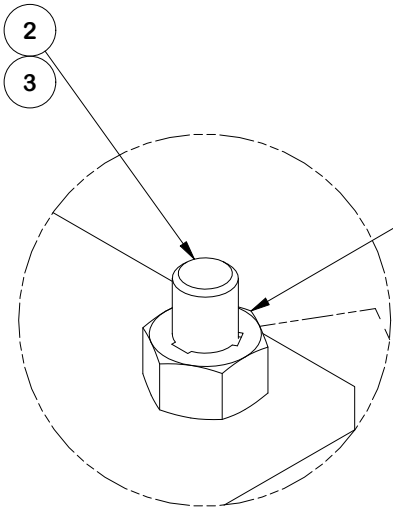

DETAIL A

**NOTE:**  
FOR TRI-LOCK NUT INSTALLATION, ENSURE THE  
GROOVED SIDE IS ORIENTED AWAY FROM THE BOLT HEAD

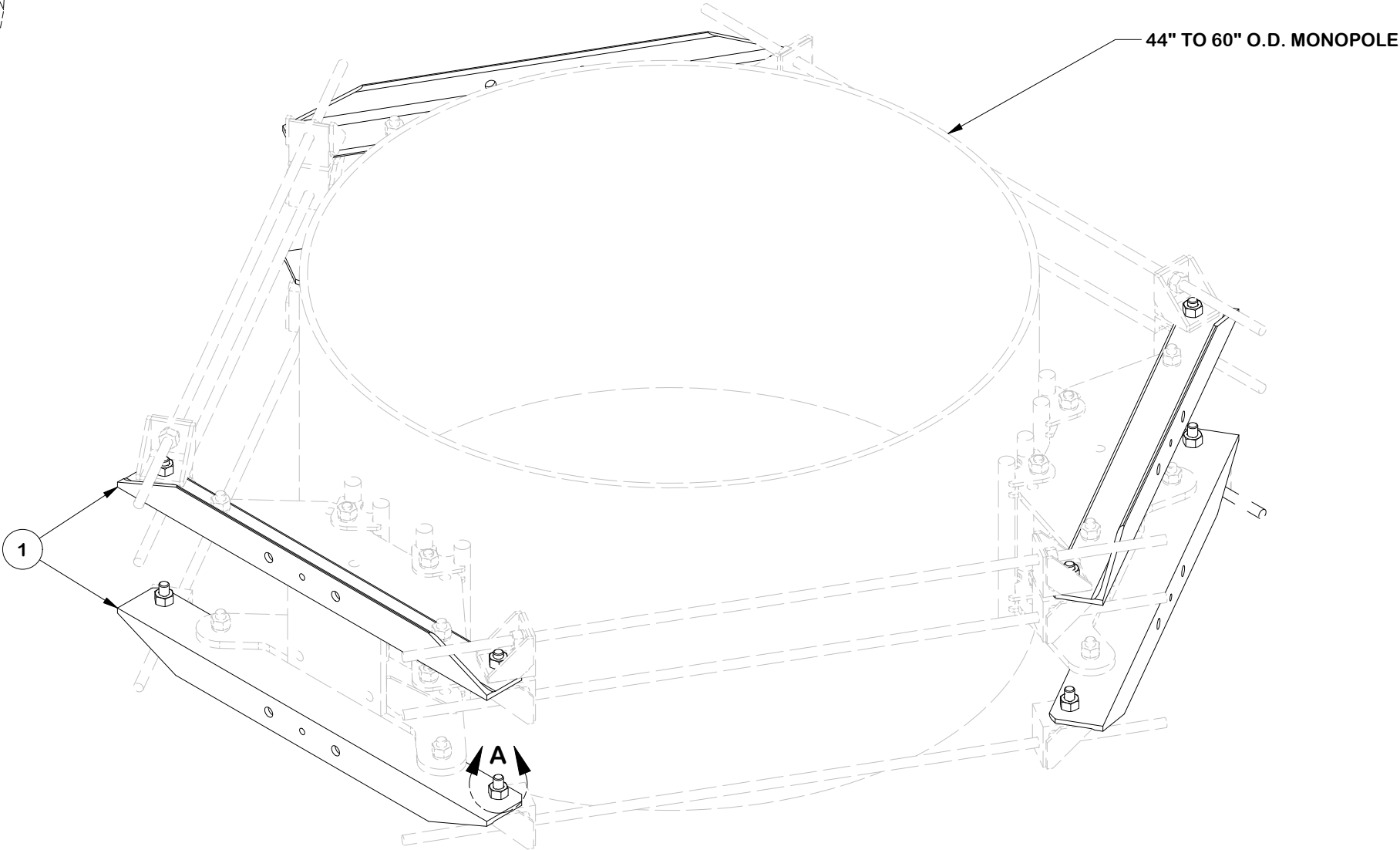

TOLERANCE NOTES

TOLERANCES ON DIMENSIONS, UNLESS OTHERWISE NOTED ARE:  
SAWED, SHEARED AND GAS CUT EDGES ( $\pm 0.030"$ )  
DRILLED AND GAS CUT HOLES ( $\pm 0.030"$ ) - NO CONING OF HOLES  
LASER CUT EDGES AND HOLES ( $\pm 0.010"$ ) - NO CONING OF HOLES  
BENDS AND ANGLES ARE  $\pm 1/2$  DEGREE  
ALL OTHER MACHINING ( $\pm 0.030"$ )  
ALL OTHER ASSEMBLY ( $\pm 0.060"$ )

PATENT INFORMATION: WWW.SITEPRO1.COM/PATENTS

PROPRIETARY NOTE:  
THE DATA AND TECHNIQUES CONTAINED IN THIS DRAWING ARE PROPRIETARY INFORMATION OF VALMONT INDUSTRIES AND CONSIDERED A TRADE SECRET. ANY USE OR DISCLOSURE WITHOUT THE CONSENT OF VALMONT INDUSTRIES IS STRICTLY PROHIBITED.

DESCRIPTION  
LONG LEG EXTENSION FOR RING MOUNT  
FOR 44" TO 60" MONOPOLE

CPD NO. SP1		DRAWN BY NSP 10/23/2024	ENG. APPROVAL 1/17/2025
CLASS 81	SUB 02	DRAWING USAGE CUSTOMER	CHECKED BY JET 1/17/2025



Engineering  
Support Team:  
sp1engineering@valmont.com

PART NO. FLX-ADK	PAGE 1 OF 1
DWG. NO. FLX-ADK	